

Eclipse RatioAir Burners

Model RA0075

Version 2

Parameter		Specifications		
		Packaged Blower Nominal (50Hz and 60Hz)		
Maximum Input, BTU/hr (kW) ^{1, 2}	Chamber Pressure "w.c. (mbar)	Straight Combustor	Medium Velocity Combustor	High Velocity Combustor*
	-2.0 (-5,0)	1,320,000 (387)	950,000 (278)	910,000 (267)
	-1.0 (-2,5)	1,210,000 (355)	890,000 (261)	870,000 (255)
	0.0 (0,0)	1,080,000 (316)	830,000 (243)	830,000 (243)
	1.0 (2,5)	950,000 (278)	760,000 (223)	790,000 (231)
2.0 (5,0)	780,000 (229)	700,000 (205)	740,000 (217)	
Minimum Input, BTU/hr (kW) <i>Lower inputs may be achieved. Contact factory.</i>		30,000 (8,8)	30,000 (8,8)	30,000 (8,8)
Main Gas Inlet Pressure, "w.c. (mbar)³ <i>Fuel pressure at ratio regulator inlet.</i>		Maximum 24 (60)	24 (60)	24 (60)
		Minimum 10 (25)	10 (25)	15 (37)
High Fire Flame Length, inches (mm) <i>Measured from the outlet end of the combustor.</i>		39 (991)	28 (711)	28 (711)
Maximum Flame Velocity, ft/s (m/s) <i>Approximately 15% excess air at maximum input.</i>		-	250 (75)	500 (150)
Maximum Application Temperature, °F (°C)		Alloy Combustor 1500 (820)	1750 (955)	1750 (955)
		SiC Combustor 1900 (1040)	2500 (1370)	2500 (1370)
		Block & Holder 1900 (1040)	2800 (1540)	2800 (1540)
Flame Detection		UV scanner available for all combustors. Flame rod available for alloy or SiC combustors.		
Blower Motor Power, Hp		60 Hz 4.2" w.c. @ 8,500 scfh, 1/2 hp	4.2" w.c. @ 8,500 scfh, 1/2 hp	10" w.c. @ 11,000 scfh, 3/4 hp
		50 Hz 4.2" w.c. @ 8,500 scfh, 0.25 kW	4.2" w.c. @ 8,500 scfh, 0.25 kW	-
Weight, lbs (kg)⁵		Alloy Combustor	112 (51)	
		Block and Holder	181 (82)	
Fuels <i>For any other mixed gas, contact Eclipse.</i>		Natural Gas, Propane, and Butane ⁴		
Approvals				

* 50 Hz Blower not available with the High Velocity Combustor.

¹ Maximum inputs for packaged blower versions are given for the standard combustion air blower without an inlet air filter.

² Blower motor service factors greater than 1.0 may be required when firing into negative chamber pressure applications. For specific application questions, contact Eclipse.

³ For proper performance, this pressure must be kept constant across the burner operating range.

⁴ See Design Guide 111 for more information about typical fuel composition and properties.

⁵ All weights are approximate.

• All inputs based upon gross calorific values and standard conditions: 1 atmosphere, 70°F (21°C).

• Blower motor service factors greater than 1.0 may be required when firing into negative chamber pressure applications. For specific application questions, contact Eclipse.

• Eclipse reserves the right to change the construction and/or configuration of our products at any time without being obliged to adjust earlier supplies accordingly.

• All information is based on laboratory testing in neutral (0.0" w.c.) chamber with standard combustor design. Different chamber conditions may affect the data.

Control & Operation Curve

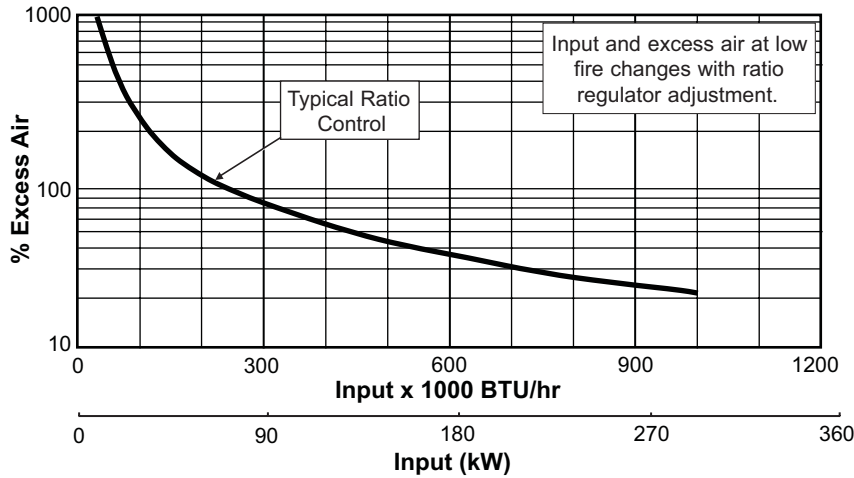

Straight Combustor Specifications

NO_x Emission Data

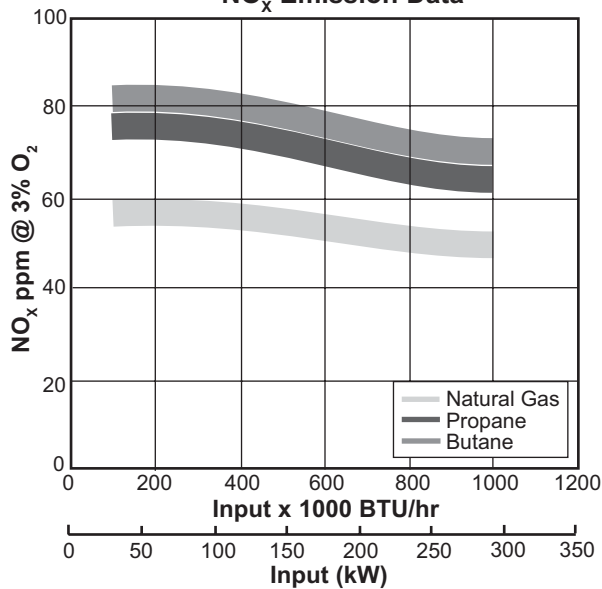

NO_x emission data is given for:

- Ambient combustion air ~70°F (20°C)
- Minimal process air velocity
- ppm volume dry at 3% O₂
- Neutral chamber pressure

Emissions are influenced by:

- Chamber conditions
- Fuel type
- Firing rate
- Ratio regulator adjustment
- Combustion air temperature

CO emission is largely influenced by chamber conditions. Contact your local Eclipse representative for an estimate of CO emission on your application.

Fuel Orifice Δp vs. Input

Δp Measured Between Taps B & D

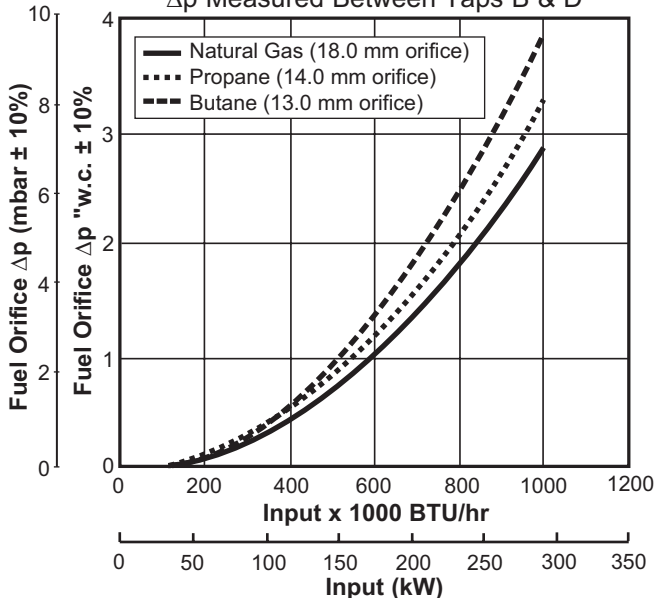

Air Δp vs. Input

(Measured Between Tap C & the Chamber with the Burner Firing)

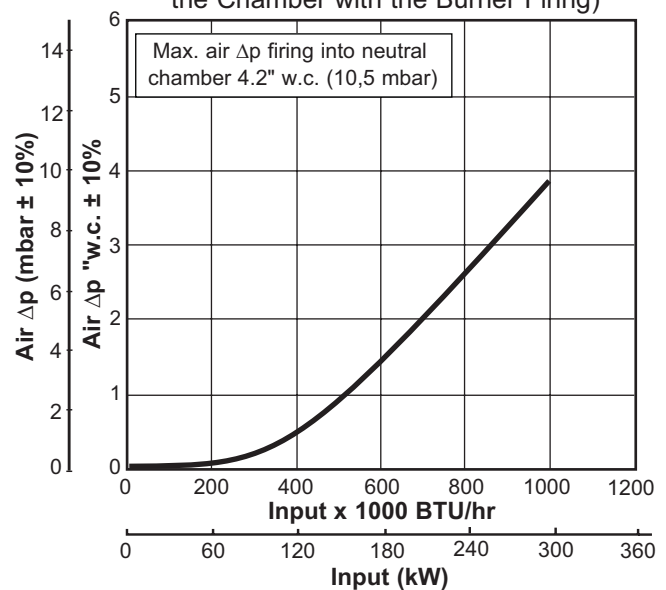

Medium Velocity Combustor Specifications

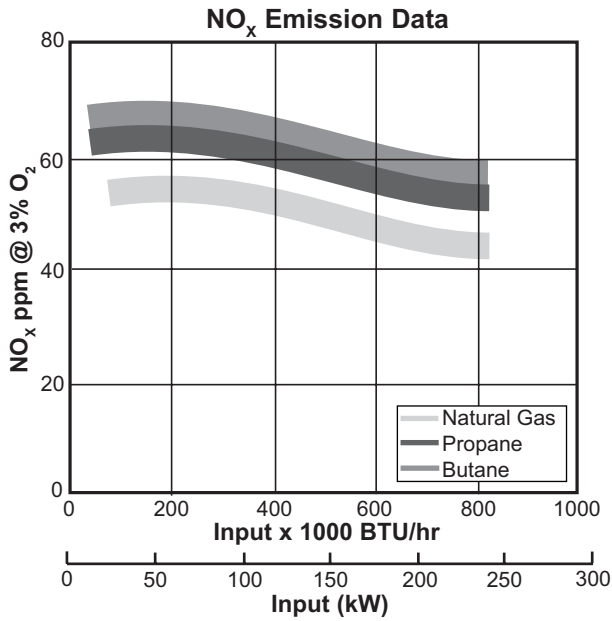

NO_x emission data is given for:

- Ambient combustion air ~70°F (20°C)
- Minimal process air velocity
- ppm volume dry at 3% O₂
- Neutral chamber pressure

Emissions are influenced by:

- Chamber conditions
- Fuel type
- Firing rate
- Ratio regulator adjustment
- Combustion air temperature

CO emission is largely influenced by chamber conditions. Contact your local Eclipse representative for an estimate of CO emission on your application.

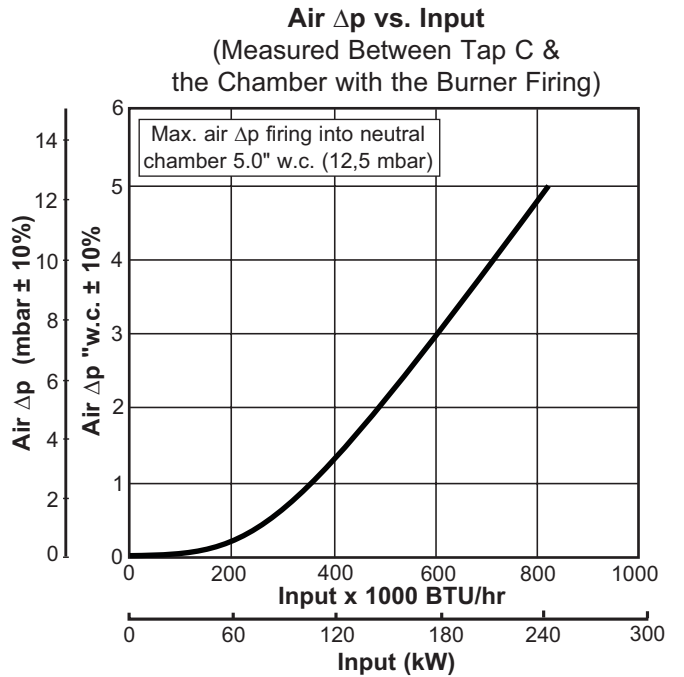
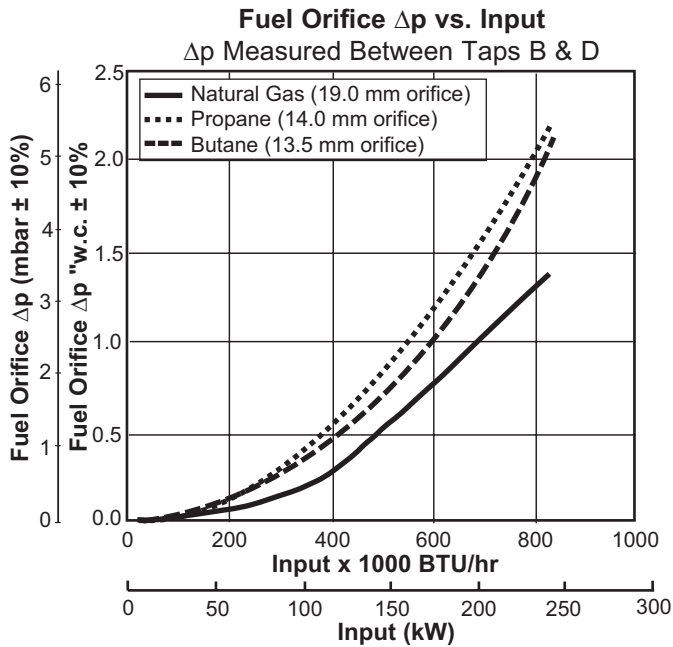

High Velocity Combustor Specifications

NO_x Emission Data

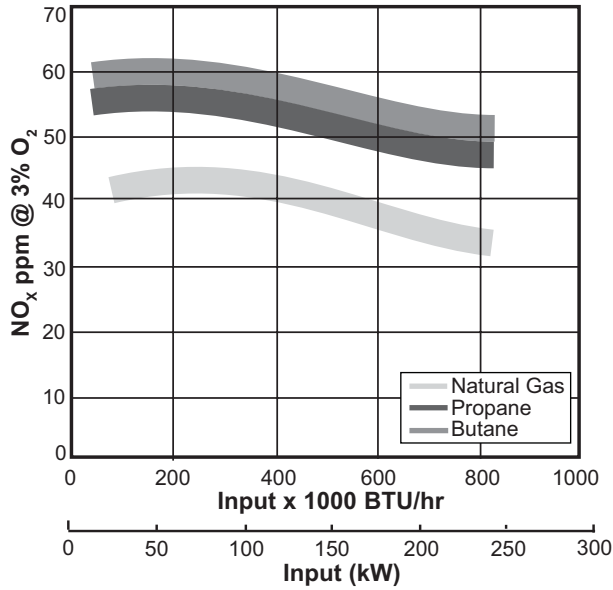

NO_x emission data is given for:

- Ambient combustion air ~70°F (20°C)
- Minimal process air velocity
- ppm volume dry at 3% O₂
- Neutral chamber pressure

Emissions are influenced by:

- Chamber conditions
- Fuel type
- Firing rate
- Ratio regulator adjustment
- Combustion air temperature

CO emission is largely influenced by chamber conditions. Contact your local Eclipse representative for an estimate of CO emission on your application.

Fuel Orifice Δp vs. Input

Δp Measured Between Taps B & D

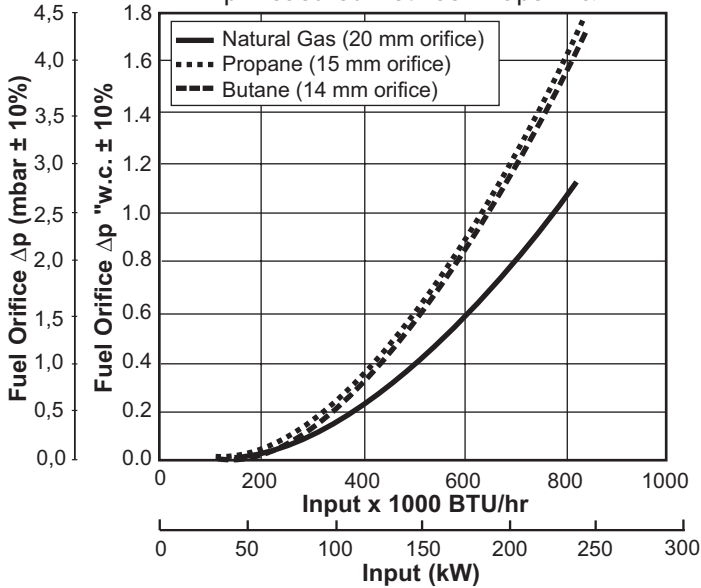

Air Δp vs. Input

(Measured Between Tap C & the Chamber with the Burner Firing)

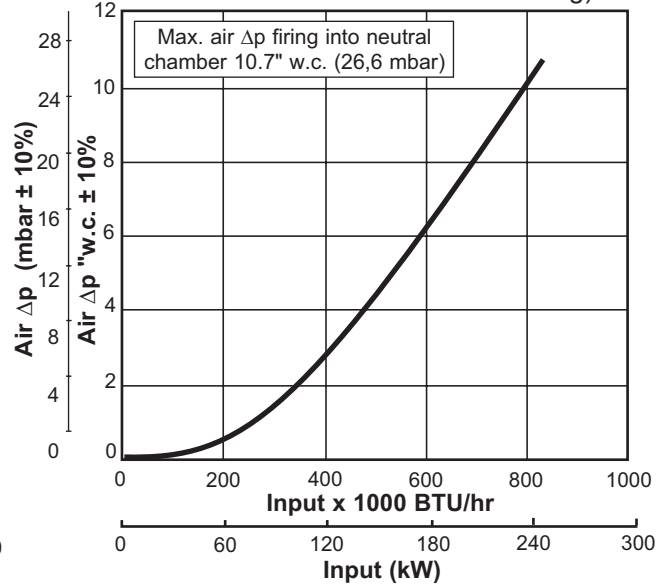

Dimensions in mm (inches)

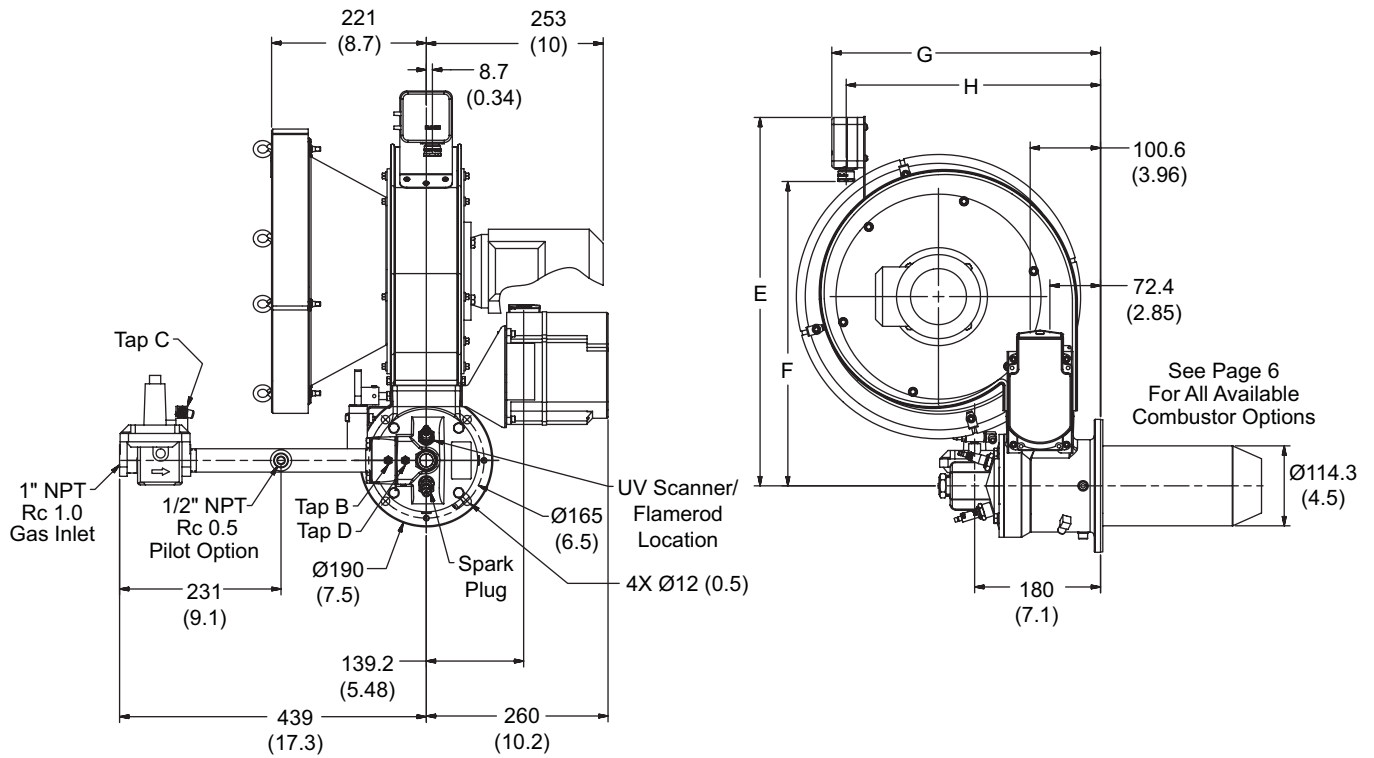

See Page 6
For All Available
Combustor Options

	Combustor Type	Filter Type	Dimensions mm (inches)			
			E	F	G	H
60 Hz Blower	Straight & Medium Velocity	Rectangular*	485 (19.1)	399 (15.7)	341 (13.4)	321 (12.6)
	High Velocity	Round	597 (23.5)	512 (20.2)	462 (18.2)	442 (17.4)
	High Velocity	Automotive*	597 (23.5)	512 (20.2)	462 (18.2)	442 (17.4)
50 Hz Blower	Straight & Medium Velocity	Round	528 (20.8)	443 (17.4)	390 (15.4)	370 (14.6)

*Standard round filters are illustrated above. Automotive filters are 508 x 508 (20 x 20).
Rectangular filter is 256 x 256 (10 x 10).

Burner Configuration & Piping Arrangement

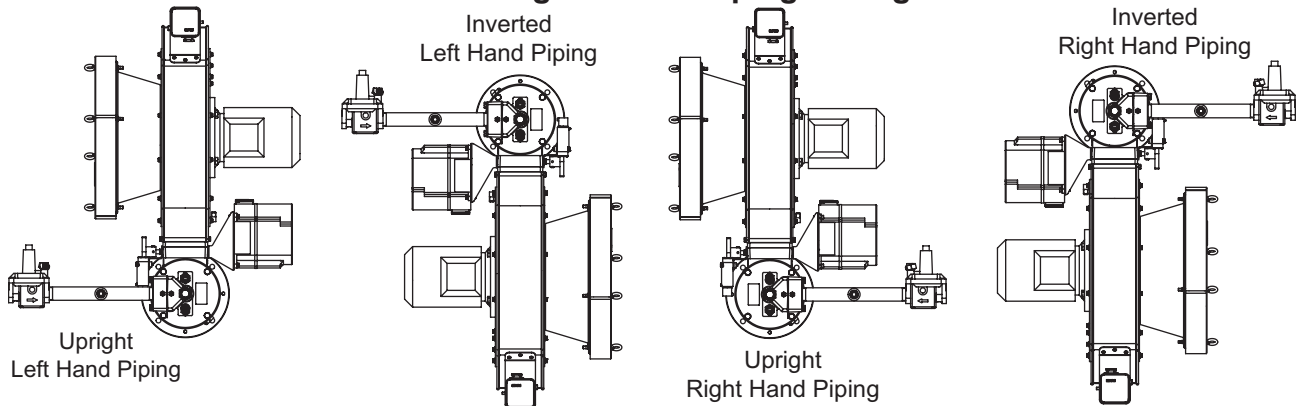

Combustor Options

Straight Alloy Combustor

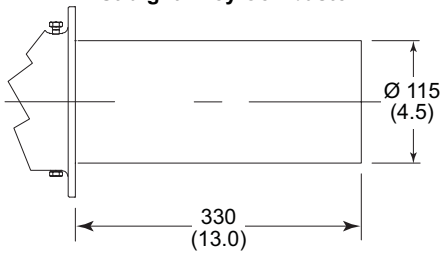

Medium & High Velocity Alloy Combustor

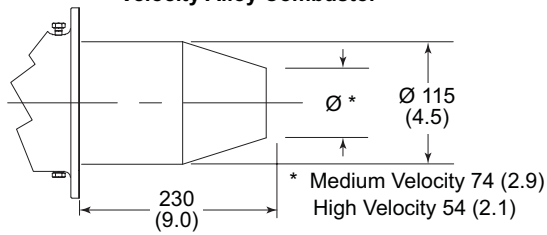

Mounting Pattern

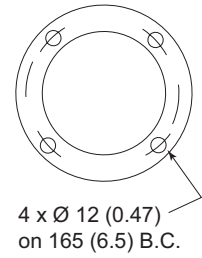

Straight SiC Combustor

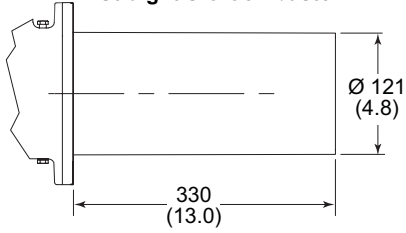

Medium & High Velocity SiC Combustor

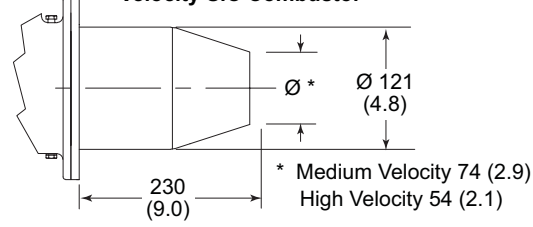

Mounting Pattern

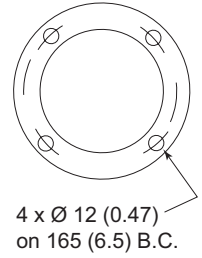

Block & Holder

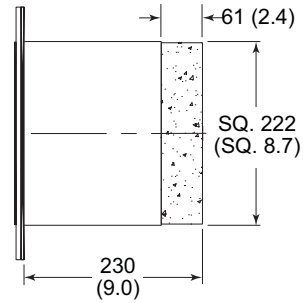
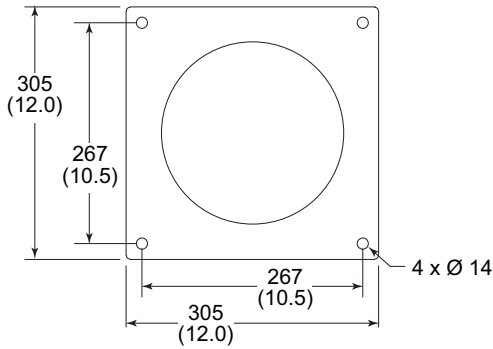



Offered By:

Power Equipment Company
2011 Williamsburg Road
Richmond, Virginia 23231
Phone (804) 236-3800
Fax (804) 236-3882

www.peconet.com